

# Overview line-setup

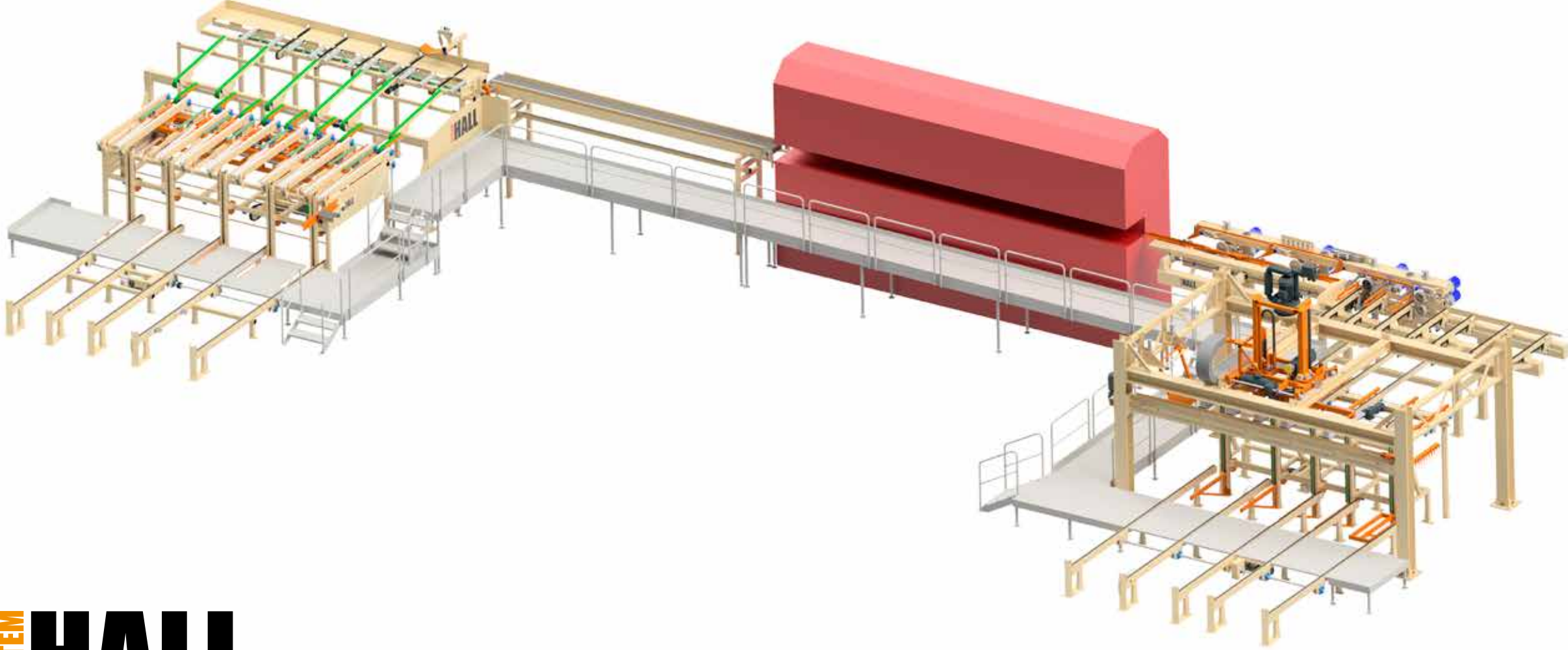

**SYSTEM HALL**

www.systemhall.com  
sales@systemhall.com  
Phone: +46(0)346 - 577 30

**SYSTEM HALL**

**SML150**

SML150 ENG 2 2023

## Small moulder line 150

**SML150** is developed for the company that handles smaller batches with customer specific orders, therefore all the equipment is easy tuned from operator panels where you can store your recipes. The line is easy to learn and good for a company that changes operators frequently.

With this line you can choose to go with or without automatic stick dispensers depending on your need. There is also space saved for additional sorting options on the outfeed if needed. The stacker comes in a high standard with even end adjuster and frequency powered motors. The vacuum lift can handle the smaller dimensions and large dimensions with no loss of efficiency, It's also standard with stick removal on the infeed.

The line is designed so that it has minimal wear parts, for example the in-feeding unit only has one pair of infeed rollers but still can handle 150 m per minute. The mechanical functions are kept at a low to keep the flexibility high.

*The rough footprint of the line is 33,05m X 12,25m*

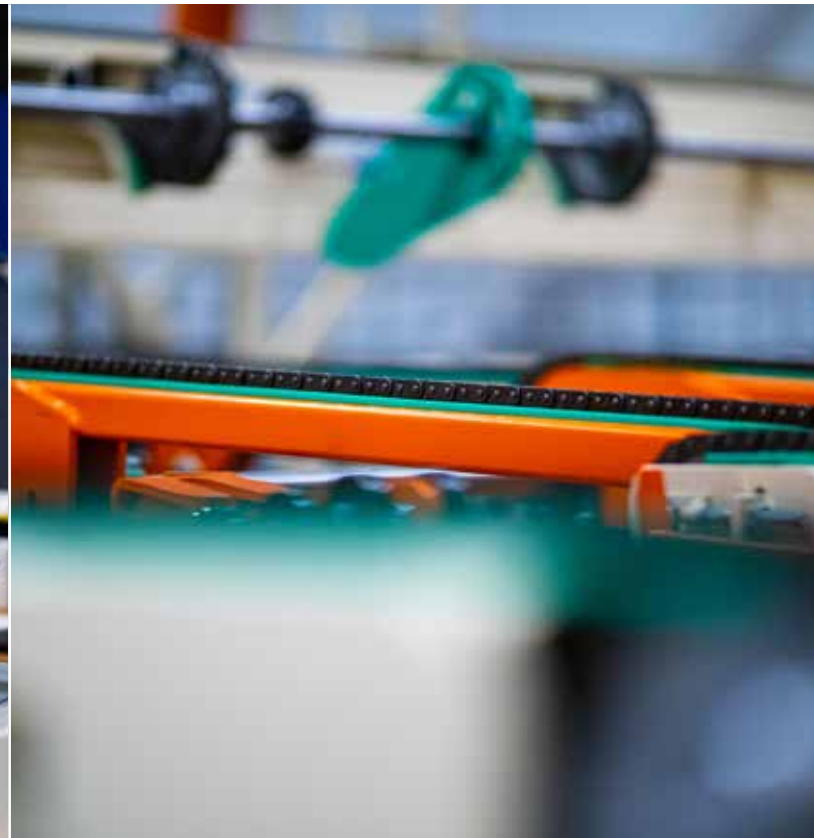

## Technical

### Small Moulder Line

Pieces per minute: 4,2 m pieces at 35 p/m, Max moulder speed 150 m/min  
Length: 1,8 – 6 m  
Max width: 245 mm  
Min width: Before moulder 70 mm. after moulder 45 mm  
Max thickness: 100 mm

Min thickness: 16 mm  
Packet size (infeed): 1,2 x 1,2 m  
Packet size (outfeed): 1,2 x 1,2 m  
Max pack weight: 4000 kg  
Color frame: RAL 1015  
Color moving parts: RAL 2004



**Sideview infeed**

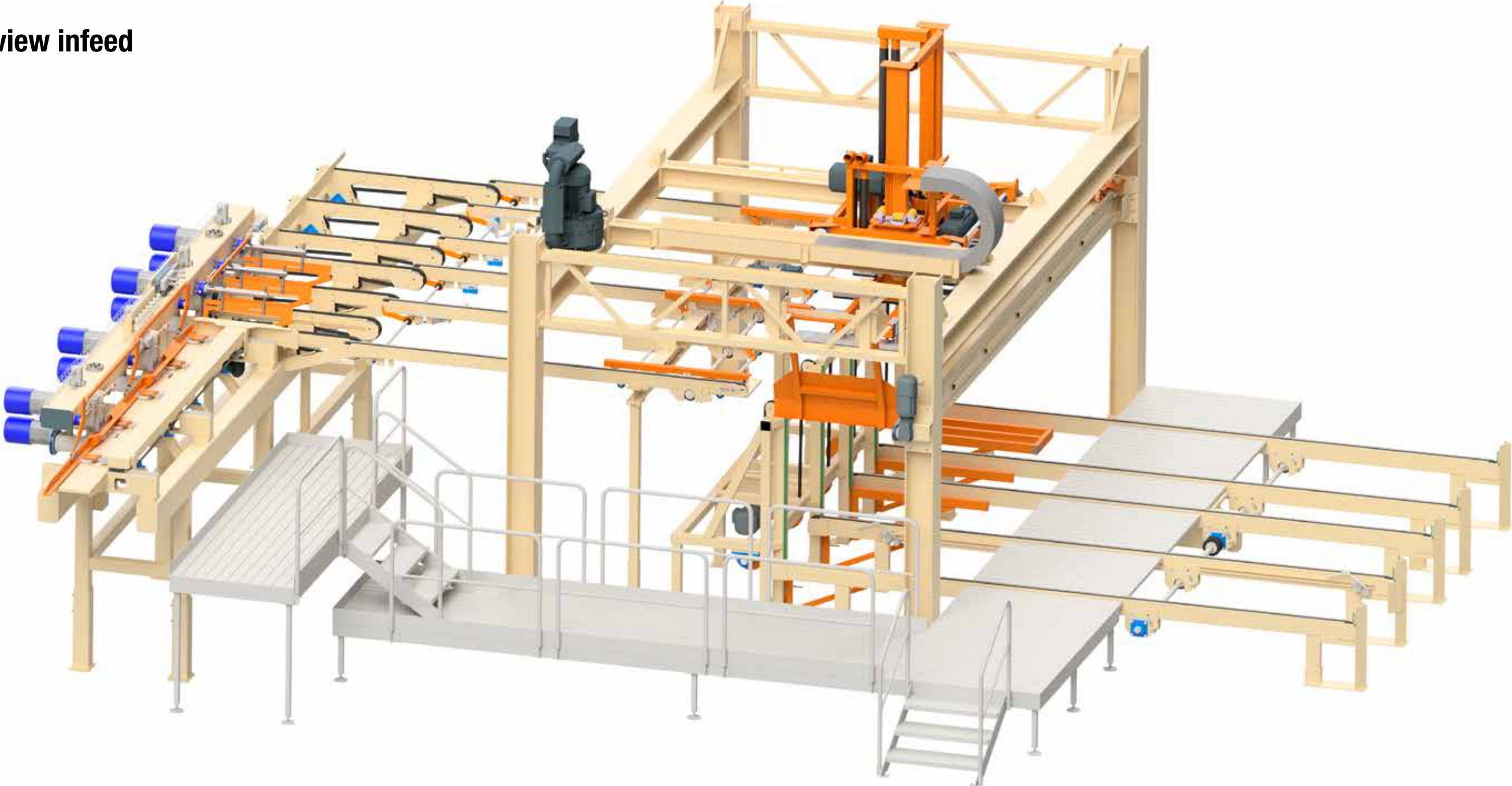

**Sideview outfeed**

